

Square Section Piston Rings Dimensions

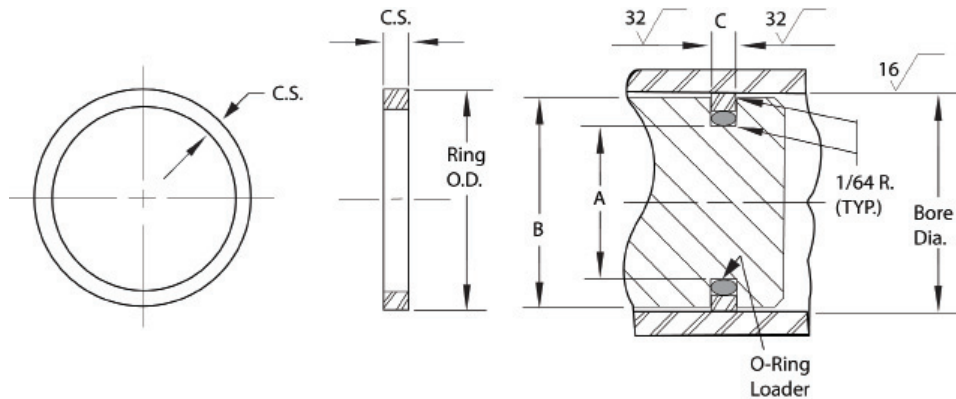

Part Number	Bore Dia. ± 0.001	A ± 0.002	B ± 0.002	C ± 0.002	Ring O.D. ± 0.5% Dia.	C/S ± 0.010	O-ring Loader No.
SPS-0500	0.500	0.241	0.497	0.083	0.511	0.070*	-009
SPS- 0750	0.750	0.491	0.747	0.083	0.761	0.070*	-013
SPS- 1000	1.000	0.741	0.997	0.083	1.011	0.070*	-017
SPS- 1200	1.250	0.991	1.247	0.083	1.261	0.070*	-022
SPS- 1500	1.500	1.241	1.497	0.083	1.511	0.070*	-025
SPS- 1750	1.750	1.360	1.747	0.122	1.771	0.109	-125
SPS- 2000	2.000	1.606	1.996	0.130	2.024	0.115	-129
SPS- 2250	2.250	1.856	2.246	0.130	2.274	0.115	-133
SPS- 2500	2.500	2.106	2.496	0.130	2.524	0.115	-137
SPS- 2750	2.750	2.356	2.746	0.130	2.774	0.115	-141
SPS- 3000	3.000	2.606	2.996	0.130	3.026	0.115	-145
SPS- 3250	3.250	2.856	3.246	0.130	3.276	0.115	-149
SPS- 3500	3.500	3.106	3.496	0.130	3.526	0.115	-151
SPS- 3750	3.750	3.356	3.746	0.130	3.776	0.115	-152
SPS- 4000	4.000	3.606	3.996	0.130	4.026	0.115	-153
SPS- 4250	4.250	3.856	4.246	0.130	4.278	0.115	-154
SPS- 4500	4.500	4.106	4.496	0.130	4.528	0.115	-155
SPS- 4750	4.750	4.356	4.746	0.130	4.778	0.115	-156
SPS- 5000	5.000	4.606	4.996	0.130	5.028	0.115	-157
SPS- 5250	5.250	4.856	5.246	0.130	5.280	0.115	-158
SPS- 5500	5.500	5.106	5.496	0.130	5.530	0.115	-159
SPS- 5750	5.750	5.232	5.746	0.159	5.780	0.143	-251
SPS- 6000	6.000	5.482	5.996	0.159	6.030	0.143	-253

*Cross-sections with an asterisk hold a ± 0.005" tolerance.

Description: A low cost, but effective seal for hydraulic and pneumatic cylinders.

Application: Excellent low friction, highly pressure sensitive seal in highly frequency cylinders. Square section piston rings are double action.

Pressure: Up to 5000 PSI.

Material & Temperature Range:

Glass filled Teflon®

Expander Materials:

Nitrile -40°C to +135°C

Viton® fluorocarbon -30°C to +204°C

Did you know...

By adding different fillers to the Teflon®, such as bronze, carbon or graphite, we can change the temperature range, friction characteristics, extrusion resistance and wearability of the piston seal.

Part Number	Bore Dia. ± 0.001	A ± 0.002	B ± 0.002	C ± 0.002	Ring O.D. ± 0.5% Dia.	C/S ± 0.010	O-ring Loader No.
SPS- 6250	6.250	5.732	6.246	0.159	6.282	0.143	-255
SPS- 6500	6.500	5.982	6.496	0.159	6.532	0.143	-257
SPS- 6750	6.750	6.232	6.746	0.159	6.782	0.143	-258
SPS- 7000	7.000	6.482	6.996	0.159	7.037	0.143	-259
SPS- 7250	7.250	6.732	7.246	0.159	7.286	0.143	-260
SPS- 7500	7.500	6.982	7.496	0.159	7.537	0.143	-261
SPS- 7750	7.750	7.232	7.746	0.159	7.789	0.143	-262
SPS- 8000	8.000	7.482	7.996	0.159	8.040	0.143	-263
SPS- 8250	8.250	7.732	8.246	0.159	8.291	0.143	-264
SPS- 8500	8.500	7.982	8.496	0.159	8.543	0.143	-265
SPS- 8750	8.750	8.232	8.746	0.159	8.794	0.143	-266
SPS- 9000	9.000	8.482	8.996	0.159	9.045	0.143	-267
SPS- 9250	9.250	8.732	9.246	0.159	9.296	0.143	-268
SPS- 9500	9.500	8.982	9.496	0.159	9.548	0.143	-269
SPS- 9750	9.750	9.232	9.746	0.159	9.799	0.143	-270
SPS- 10000	10.000	9.482	9.996	0.159	10.050	0.143	-271
SPS- 10250	10.250	9.732	10.246	0.159	10.301	0.143	-272
SPS- 10500	10.500	9.982	10.496	0.159	10.550	0.143	-273
SPS- 10750	10.750	10.232	10.746	0.159	10.804	0.143	-274
SPS- 11000	11.000	10.482	10.996	0.159	11.055	0.143	-275
SPS- 11500	11.500	10.982	11.496	0.159	11.558	0.143	-276
SPS- 12000	12.000	11.482	11.996	0.159	12.060	0.143	-277
SPS- 13000	13.000	12.482	12.996	0.159	13.065	0.143	-278

EDMONTON, AB
9211- 41 Avenue NW
(780)-438-6055
Toll Free: (800)-661-6055

CALGARY, AB
Bay #3, 5940- 30 Street SE
(403)-720-2856
Toll Free: (800)-830-7822

NEWMARKET, ON
1180 Kerrisdale Blvd; Unit #8
(905)-953-9666
Toll Free: (877)-296-9412

BOUCHERVILLE, QC
1450 Rue Nobel, Suite #20
(450)-655-7325
Toll Free: (866)-894-7325

www.hitechseals.com ---info@hitechseals.com

08/09

Teflon® is a registered trademark of DuPont™.
Viton® is a registered trademark of DuPont Performance Elastomers.