

Pressure Inverting Pedestal

| Materials: | Temp. Range | | |
|--------------------------|-------------|----|-------|
| Urethane | -54°C | to | 105°C |
| Hytrel® | -54°C | to | 149°C |
| Nylon | -30°C | to | 93°C |
| Highly Saturated Nitrile | -40°C | to | 160°C |
| Nitrile | -40°C | to | 120°C |
| Viton®/Fluorocarbon | -26°C | to | 204°C |
| PTFE | -268 °C | to | 232°C |

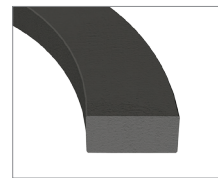

LIP

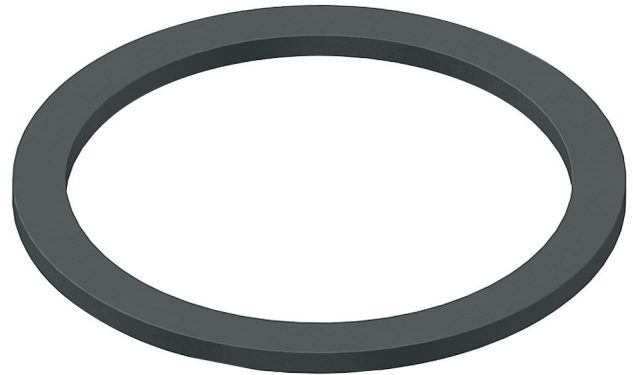

PIP

Product Description:

Pressure Inverting Pedestals are designed to convert a loaded U-cup into a bi-directional seal for high pressure applications. The LIP profile is rectangular in shape which makes it compatible with both Quad loaded U-cups and O-ring loaded U-cups. The PIP ring design is only functional in conjunction with a O-ring loaded U-cup. For gland dimension and design information, please contact a Hi-Tech Seals' representative.

PTFE Back-up rings can function as a LIP ring for beveled loaded U-cups in low to medium pressure applications. Consult a Hi-Tech Seals' representative before substituting.

Part Numbers:

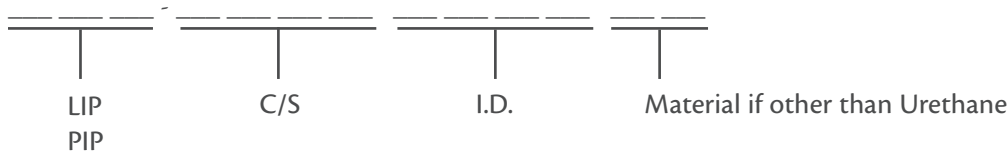

Example: PIP 2500 3000 - Urethane PIP Ring, 1/4" C/S, 3" I.D., 3 - 1/2" O.D.