

Raise Faced Gasket  
(RFG)

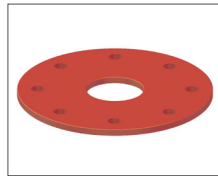

Full Face Gasket  
(FFG)

## Product Description:

Hi-Tech Gaskets utilizes an extensive inventory of sheet material to rapidly manufacture gaskets for ASME B16.21 pipe flanges and flange fittings. Sizes are available for class 150#, 300#, 400#, 600#, 900#, 1500# and 2500#. If you have a custom size pipe flange gasket, Hi-Tech Gaskets can manufacture replacement gaskets from a sample or metal dimensions.

## Part Number:

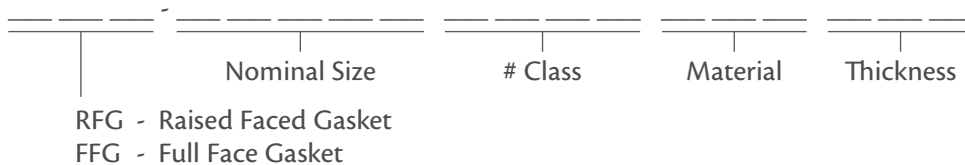

**Example:** RFG 4000 0900 RR 125 - Raised Faced Gasket - 4" Nom., 900#, Red Rubber - 1/8" thick - 4-1/2" I.D., 8-1/8" O.D.

## Standard 150# forged Steel Pipe Flange Gasket Dimensions

Nominal Size	Raised Face Gasket		Full Face Gasket				
	OD	ID	OD	ID	No. Bolts	Hole Diameter	B.C.D.
1/2	1-7/8	27/32	3-1/2	27/32	4	5/8	2-3/8
3/4	2-1/4	1-1/16	3-7/8	1-1/16	4	5/8	2-3/4
1	2-5/8	1-5/16	4-1/4	1-5/16	4	5/8	3-1/8
1-1/4	3	1-21/32	4-5/8	1-21/32	4	5/8	3-1/2
1-1/2	3-3/8	1-29/32	5	1-29/32	4	5/8	3-7/8
2	4-1/8	2-3/8	6	2-3/8	4	3/4	4-3/4
2-1/2	4-7/8	2-7/8	7	2-7/8	4	3/4	5-1/2
3	5-3/8	3-1/2	7-1/2	3-1/2	4	3/4	6
3-1/2	6-3/8	4	8-1/2	4	8	3/4	7
4	6-7/8	4-1/2	9	4-1/2	8	3/4	7-1/2
5	7-3/4	5-9/16	10	5-9/16	8	7/8	8-1/2
6	8-3/4	6-5/8	11	6-5/8	8	7/8	9-1/2
8	11	8-5/8	13-1/2	8-5/8	8	7/8	11-3/4
10	13-3/8	10-3/4	16	10-3/4	12	1	14-1/4
12	16-1/8	12-3/4	19	12-3/4	12	1	17
14	17-3/4	14	21	14	12	1-1/8	18-3/4
16	20-1/4	16	23-1/2	16	16	1-1/8	21-1/4
18	21-5/8	18	25	18	16	1-1/4	22-3/4
20	23-7/8	20	27-1/2	20	20	1-1/4	25
24	28-1/4	24	32	24	20	1-3/8	29-1/2

## Standard 300# forged Steel Pipe Flange Gasket Dimensions

Nominal Size	Raised Face Gasket		Full Face Gasket				
	OD	ID	OD	ID	No. Bolts	Hole Diameter	B.C.D.
1/2	2-1/8	27/32	3-3/4	27/32	4	5/8	2-5/8
3/4	2-5/8	1-1/16	4-5/8	1-1/16	4	3/4	3-1/4
1	2-7/8	1-5/16	4-7/8	1-5/16	4	3/4	3-1/2
1-1/4	3-1/4	1-21/32	5-1/4	1-21/32	4	3/4	3-7/8
1-1/2	3-3/4	1-29/32	6-1/8	1-29/32	4	7/8	4-1/2
2	4-3/8	2-3/8	6-1/2	2-3/8	8	3/4	5
2-1/2	5-1/8	2-7/8	7-1/2	2-7/8	8	7/8	5-7/8
3	5-7/8	3-1/2	8-1/4	3-1/2	8	7/8	6-5/8
3-1/2	6-1/2	4	9	4	8	7/8	7-1/4
4	7-1/8	4-1/2	10	4-1/2	8	7/8	7-7/8
5	8-1/2	5-9/16	11	5-9/16	8	7/8	9-1/4
6	9-7/8	6-5/8	12-1/2	6-5/8	12	7/8	10-5/8
8	12-1/8	8-5/8	15	8-5/8	12	1	13
10	14-1/4	10-3/4	17-1/2	10-3/4	16	1 1/8	15-1/4
12	16-5/8	12-3/4	20-1/2	12-3/4	16	1 1/4	17-3/4
14	19-1/8	14	23	14	20	1 1/4	20-1/4
16	21-1/4	16	25-1/2	16	20	1 3/8	22-1/2
18	23-1/2	18	28	18	24	1 3/8	24-3/4
20	25-3/4	20	30-1/2	20	24	1 3/8	27
24	30-1/2	24	36	24	24	1 5/8	32

B.C.D. - Bolt Circle Diameter



## Standard 400# Pipe Flange Gasket Dimensions

Nominal Size	Raised Face Gasket		Full Face Gasket				
	OD	ID	OD	ID	No. Bolts	Hole Diameter	B.C.D.
1/2	2-1/8	27/32	3-3/4	27/32	4	5/8	2-5/8
3/4	2-5/8	1-1/16	4-5/8	1-1/16	4	3/4	3-1/4
1	2-7/8	1-5/16	4-7/8	1-5/16	4	3/4	3-1/2
1-1/4	3-1/4	1-21/32	5-1/4	1-21/32	4	3/4	3-7/8
1-1/2	3-3/4	1-29/32	6-1/8	1-29/32	4	7/8	4-1/2
2	4-3/8	2-3/8	6-1/2	2-3/8	8	3/4	5
2-1/2	5-1/8	2-7/8	7-1/2	2-7/8	8	7/8	5-7/8
3	5-7/8	3-1/2	8-1/4	3-1/2	8	7/8	6-5/8
3-1/2	6-3/8	4	9	4	8	1	7-1/4
4	7	4-1/2	10	4-1/2	8	1	7-7/8
5	8-3/8	5-9/16	11	5-9/16	8	1	9-1/4
6	9-3/4	6-5/8	12-1/2	6-5/8	12	1	10-5/8
8	12	8-5/8	15	8-5/8	12	1-1/8	13
10	14-1/8	10-3/4	17-1/2	10-3/4	16	1-1/4	15-1/4
12	16-1/2	12-3/4	20-1/2	12-3/4	16	1-3/8	17-3/4
14	19	14	23	14	20	1-3/8	20-1/4
16	21-1/8	16	25-1/2	16	20	1-1/2	22-1/2
18	23-3/8	18	28	18	24	1-1/2	24-3/4
20	25-1/2	20	30-1/2	20	24	1-5/8	27
24	30-1/4	24	36	24	24	1-7/8	32

## Standard 600# Pipe Flange Gasket Dimensions

Nominal Size	Raised Face Gasket		Full Face Gasket				
	OD	ID	OD	ID	No. Bolts	Hole Diameter	B.C.D.
1/2	2-1/8	27/32	3-3/4	27/32	4	5/8	2-5/8
3/4	2-5/8	1-1/32	4-5/8	1-1/16	4	3/4	3-1/4
1	2-7/8	1-5/16	4-7/8	1-5/16	4	3/4	3-1/2
1-1/4	3-1/4	1-21/32	5-1/4	1-21/32	4	3/4	3-7/8
1-1/2	3-3/4	1-29/32	6-1/8	1-29/32	4	7/8	4-1/2
2	4-3/8	2-3/8	6-1/2	2-3/8	8	3/4	5
2-1/2	5-1/8	2-7/8	7-1/2	2-7/8	8	7/8	5-7/8
3	5-7/8	3-1/2	8-1/4	3-1/2	8	7/8	6-5/8
3-1/2	6-3/8	4	9	4	8	1	7-1/4
4	7-5/8	4-1/2	10-3/4	4-1/2	8	1	8-1/2
5	9-1/2	5-9/16	13	5-9/16	8	1-1/8	10-1/2
6	10-1/2	6-5/8	14	6-5/8	12	1-1/8	11-1/2
8	12-5/8	8-5/8	16-1/2	8-5/8	12	1-1/4	13-3/4
10	15-3/4	10-3/4	20	10-3/4	16	1-3/8	17
12	18	12-3/4	22	12-3/4	20	1-3/8	19-1/4
14	19-3/8	14	23-3/4	14	20	1-1/2	20-3/4
16	22-1/4	16	27	16	20	1-5/8	23-3/4
18	24-1/8	18	29-1/4	18	20	1-3/4	25-3/4
20	26-7/8	20	32	20	24	1-3/4	28-1/2
24	31-1/8	24	37	24	24	2	33

B.C.D. - Bolt Circle Diameter

## Standard 900# Pipe Flange Gasket Dimensions

Nominal Size	Raised Face Gasket		Full Face Gasket				
	OD	ID	OD	ID	No. Bolts	Hole Diameter	B.C.D.
1/2	2-1/2	27/32	4-3/4	27/32	4	7/8	3-1/4
3/4	2-3/4	1-1/16	5-1/8	1-1/16	4	7/8	3-1/2
1	3-1/8	1-5/16	5-7/8	1-5/16	4	1	4
1-1/4	3-1/2	1-21/32	6-1/4	1-21/32	4	1	4-3/8
1-1/2	3-7/8	1-29/32	7	1-29/32	4	1-1/8	4-7/8
2	5-5/8	2-3/8	8-1/2	2-3/8	8	1	6-1/2
2-1/2	6-1/2	2-7/8	9-5/8	2-7/8	8	1-1/8	7-1/2
3	6-5/8	3-1/2	9-1/2	3-1/2	8	1	7-1/2
3-1/2	-	-	-	-	-	-	-
4	8-1/8	4-1/2	11-1/2	4-1/2	8	1-1/4	9-1/4
5	9-3/4	5-9/16	13-3/4	5-9/16	8	1-3/8	11
6	11-3/8	6-5/8	15	6-5/8	12	1-1/4	12-1/2
8	14-1/8	8-5/8	18-1/2	8-5/8	12	1-1/2	15-1/2
10	17-1/8	10-3/4	21-1/2	10-3/4	16	1-1/2	18-1/2
12	19-5/8	12-3/4	24	12-3/4	20	1-1/2	21
14	20-1/2	14	25-1/4	14	20	1-5/8	22
16	22-5/8	16	27-3/4	16	20	1-3/4	24-1/4
18	25-1/8	18	31	18	20	2	27
20	27-1/2	20	33-3/4	20	20	2-1/8	29-1/2
24	33	24	41	24	20	2-5/8	35-1/2

## Standard 1500# Pipe Flange Gasket Dimensions

Nominal Size	Raised Face Gasket		Full Face Gasket				
	OD	ID	OD	ID	No. Bolts	Hole Diameter	B.C.D.
1/2	2-1/2	27/32	4-3/4	27/32	4	7/8	3-1/4
3/4	2-3/4	1-1/16	5-1/8	1-1/16	4	7/8	3-1/2
1	3-1/8	1-5/16	5-7/8	1-5/16	4	1	4
1-1/4	3-1/2	1-21/32	6-1/4	1-21/32	4	1	4-3/8
1-1/2	3-7/8	1-29/32	7	1-29/32	4	1-1/8	4-7/8
2	5-5/8	2-3/8	8-1/2	2-3/8	8	1	6-1/2
2-1/2	6-1/2	2-7/8	9-5/8	2-7/8	8	1-1/8	7-1/2
3	6-7/8	3-1/2	10-1/2	3-1/2	8	1-1/4	8
3-1/2	-	-	-	-	-	-	-
4	8-1/8	4-1/2	12-1/4	4-1/2	8	1-3/8	9-1/2
5	10	5-9/16	14-3/4	5-9/16	8	1-5/8	11-1/2
6	11-1/8	6-5/8	15-1/2	6-5/8	12	1-1/2	12-1/2
8	13-7/8	8-5/8	19	8-5/8	12	1-3/4	15-1/2
10	17-1/8	10-3/4	23	10-3/4	12	2	19
12	20-1/2	12-3/4	26-1/2	12-3/4	16	2-1/8	22-1/2
14	22-3/4	14	29-1/2	14	16	2-3/8	25
16	25-1/4	16	32-1/2	16	16	2-5/8	27-3/4
18	27-3/4	18	36	18	16	2-7/8	30-1/2
20	29-3/4	20	38-3/4	20	16	3-1/8	32-3/4
24	35-1/2	24	46	24	16	3-5/8	39

B.C.D. - Bolt Circle Diameter



## Standard 2500# Pipe Flange Gasket Dimensions

Nominal Size	Raised Face Gasket		Full Face Gasket				
	OD	ID	OD	ID	No. Bolts	Hole Diameter	B.C.D.
1/2	2-3/4	27/32	5-1/4	27/32	4	7/8	3-1/2
3/4	3	1-1/16	5-1/2	1-1/16	4	7/8	3-3/4
1	3-3/8	1-5/16	6-1/4	1-5/16	4	1	4-1/4
1-1/4	4-1/4	1-21/32	7-1/4	1-21/32	4	1	5-1/8
1-1/2	4-5/8	1-29/32	8	1-29/32	4	1-1/4	5-3/4
2	5-3/4	2-3/8	9-1/4	2-3/8	8	1-1/8	6-3/4
2-1/2	6-5/8	2-7/8	10-1/2	2-7/8	8	1-1/4	7-3/4
3	7-3/4	3-1/2	12	3-1/2	8	1-3/8	9
3-1/2	-	-	-	-	-	-	-
4	9-1/4	4-1/2	14	4-1/2	8	1-5/8	10-3/4
5	11	5-9/16	16-1/2	5-9/16	8	1-7/8	12-3/4
6	12-1/2	6-5/8	19	6-5/8	8	2-1/8	14-1/2
8	15-1/4	8-5/8	21-3/4	8-5/8	12	2-1/8	17-1/4
10	18-3/4	10-3/4	26-1/2	10-3/4	12	2-5/8	21-1/4
12	21-5/8	12-3/4	30	12-3/4	12	2-7/8	24-3/8
14	-	-	-	-	-	-	-
16	-	-	-	-	-	-	-
18	-	-	-	-	-	-	-
20	-	-	-	-	-	-	-
24	-	-	-	-	-	-	-

B.C.D. - Bolt Circle Diameter