

Materials	Temp. Range		
Nylon/Polyamide (PA)	-30°C	to	93°C
Hytre [®] /Fluorotrel [™] (TPC-ET)	-54°C	to	149°C
Polytetrafluoroethylene (PTFE)	-260°C	to	260°C
Urethane (PU)	-54°C	to	105°C

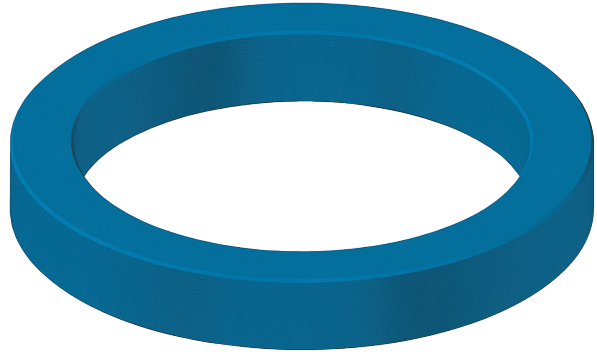

Modular Bearings

Product Description

Modular bearings are used in both rod and piston applications. They act as a wear and load bearing surface to help extend the life of a loaded or unloaded U-cup. The standard material of modular bearings is PA.

Part Numbers:

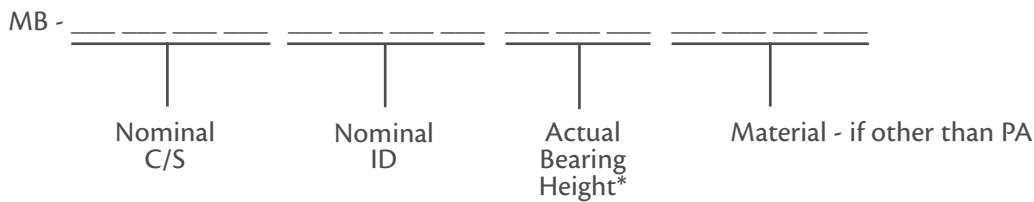

** Height is only listed if the axial height is greater than the cross-section.*

Example: MB - 25001750 H - Modular Bearing, Hytre[®], 1 - 3/4" Nominal ID, 2 - 1/4" Nominal OD, 1/4" Nominal C/S, 1/4" Nominal Height