

Materials	Temp. Range		
Stainless Steel 304	-200°C	to	460°C
Stainless Steel 316	-200°C	to	420°C
Low Carbon Steel	-100°C	to	500°C
Soft Iron	-100°C	to	500°C

** Stainless steel 316 and 304 can exceed their continuous operating temperatures, up to 760°C, for short-term intervals. However, this may result in intergranular corrosion.*

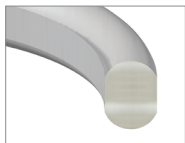

R Oval

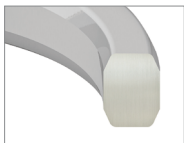

R Octagonal



RX



BX

Product Description

Hi-Tech Seals stocks ring type joint gaskets in R oval, R octagonal, RX, and BX styles. In addition, we stock test gaskets in urethane and rubber coated styles. In addition, we offer BoKure™ urethane ring type joint gaskets (RTJU) and rubber coated styles.

Part Numbers:

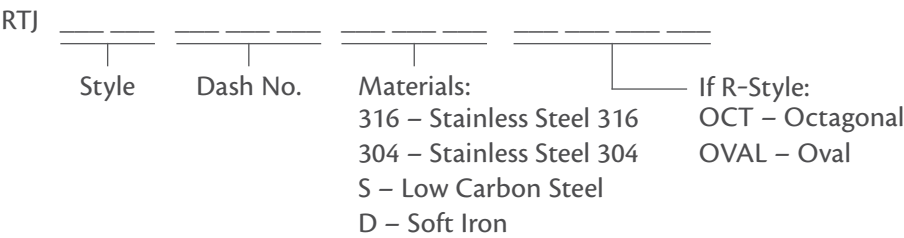

Example: RTJ R20 316 OVAL – Ring Type Joint Gasket, R Style, Size 20, Stainless Steel 316, Oval profile

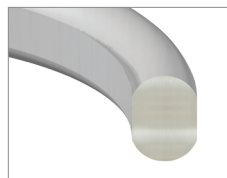

R Oval

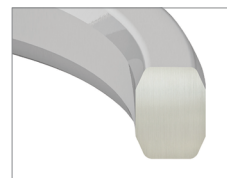

R Octagonal

Manufactured in accordance with ASME B16.20 or API 6A.

Used in API 6B and ASME B16.5 flanges.

R-series ring type joint gaskets are available in oval and octagonal designs. The oval design can be used in older round-bottom gland designs, while both can be used in a flat-bottom design.

Metal RTJ R-Series are rated up to 5000 psi.

Pipe Size	Ring # at Pressure Class						
	150	300	400	600	900	1500	2500
1/2	–	R11	–	R11	R12	R12	R13
3/4	–	R13	–	R13	R14	R14	R16
1	R15	R16	–	R16	R16	R16	R18
1 1/4	R17	R18	–	R18	R18	R18	R21
1 1/2	R19	R/RX20	–	R/RX20	R/RX20	R/RX20	R/RX23
2	R22	R/RX23	–	R/RX23	R/RX24	R/RX24	R/RX26
2 1/2	R/RX25	R/RX26	–	R/RX26	R/RX27	R/RX27	R28
3	R29	R/RX31	–	R/RX31	R/RX31	R/RX35	R32
3 1/2	R33	R34	–	R34	–	–	–
4	R36	R/RX37	R/RX37	R/RX37	R/RX37	R/RX39	R38
5	R40	R/RX41	R/RX41	R/RX41	R/RX41	R/RX44	R42
6	R43	R/RX45	R/RX45	R/RX45	R/RX45	R/RX46	R/RX47
8	R48	R/RX49	R/RX49	R/RX49	R/RX49	R/RX50	R51
10	R52	R/RX53	R/RX53	R/RX53	R/RX53	R/RX54	R55
12	R56	R/RX57	R/RX57	R/RX57	R/RX57	R58	R60
14	R59	R61	R61	R61	R62	R/RX63	–
16	R64	R/RX65	R/RX65	R/RX65	R/RX66	R67	–
18	R68	R/RX69	R/RX69	R/RX69	R/RX70	R71	–
20	R72	R/RX73	R/RX73	R/RX73	R/RX74	R75	–
24	R76	R77	R77	R77	R78	R79	–

RX Series

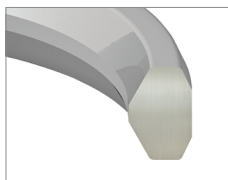

RX

Manufactured in accordance with ASME B16.20 or API 6A.

Used in API 6B and ASME B16.5 flanges

RX-series are interchangeable with R-series octagonal gaskets.

Metal RTJ RX-Series are rated up to 5000 psi.

R and RX

Pipe Size	Ring # at Pressure Class		
	2000	3000	5000
2 1/6	R/RX23	R/RX24	R/RX24
2 9/16	R/RX26	R/RX27	R/RX27
3 1/8	R/RX31	R/RX31	R/RX35
4 1/16	R/RX37	R/RX37	R/RX39
5 1/8	R/RX41	R/RX41	R/RX44
7 1/16	R/RX45	R/RX45	R/RX46
9	R/RX49	R/RX49	R/RX50
11	R/RX53	R/RX53	R/RX54
13 5/8	R/RX57	R/RX57	—
16 3/4	R/RX65	R/RX66	—
20 3/4	—	R/RX74	—
21 1/4	R/RX73	—	—

R or RX

Pipe Size	Ring # at Pressure Class	
	300-600	900
26	R93	R100
28	R94	R101
30	R95	R102
32	R96	R103
34	R97	R104
36	R98	R105



BX

Manufactured in accordance with ASME B16.20, API 6A and API 17D.

Only used in API 6BX flanges.

BX-series ring type joint gaskets feature a pressure relief vent.

Metal RTJ BX-Series are rated up to 20000 psi.

Pipe Size	Ring # at Pressure Class					
	2000	3000	5000	10000	15000	20000
1 11/16	–	–	–	BX150	BX150	–
1 13/16	–	–	–	BX151	BX151	BX151
2 1/16	–	–	–	BX152	BX152	BX152
2 9/16	–	–	–	BX153	BX153	BX153
3 1/16	–	–	–	BX154	BX154	BX154
4 1/16	–	–	–	BX155	BX155	BX155
5 1/8	–	–	–	BX169	BX169	–
7 1/16	–	–	–	BX156	BX156	BX156
9	–	–	–	BX157	BX157	BX157
11	–	–	–	BX158	BX158	BX158
13 5/8	–	–	BX160	BX159	BX159	BX159
16 3/4	–	–	BX162	BX162	–	–
18 3/4	–	–	BX163	BX164	BX164	–
21 1/4	–	–	BX165	BX166	–	–
26 3/4	BX167	BX168	–	–	–	–
30	BX303	BX303	–	–	–	–



Materials	Temp. Range
Bokure™ Urethane	-30°C to 110°C

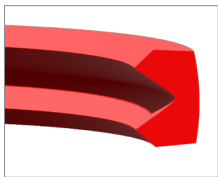

R Style

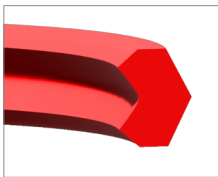

BX Style

Product Description

Our urethane ring joint test gaskets (RTJU) are a non-damaging method to test and recertify ring type joint flanges. The uniquely shaped profile energizes the seal in the groove under pressure, retrofitting into R, RX or BX ring type joint gasket grooves.

RTJUs are used in numerous critical applications across various markets that use ring type joint gaskets, including BOP control valves, wireline control valves, and wellheads. They are manufactured in-house from our BoKure™ urethane MU90. This material exhibits remarkable pressure handling and rebound capabilities.

RTJU advantages:

- Re-usable
- Cost effective
- Non-damaging method for testing your flanges
- Rapid turnover for standard and non-standard groove sizes
- Suitable for water and nitrogen pressure tests

The RTJU test gaskets are designed to be used and tested for the same conditions that the equivalent metal RTJ gasket would be used in. These gaskets are for test purposes only and are not to be used for permanent installation. RTJU gaskets are not certified under API or ASME. Proper installation and flange conditions will impact the test gasket performance. Please note that bolt up procedures do not change when using RTJU's.

Part Numbers:

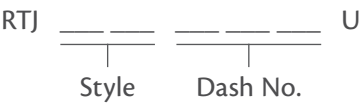

Example: RTJ R169U – Urethane Test Gasket, R Style, Size 169