

Spherical Plain Bearings

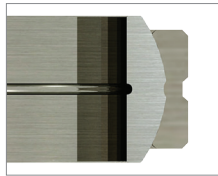

Material	Temp. Range
Steel-On-Steel*	-60°C to 300°C

* Load carrying capacity is reduced at temperatures exceeding 180°C. Lubricant temperature ranges must also be taken into account. Contact us if an application experiences a high temperature range.



Non-Sealed

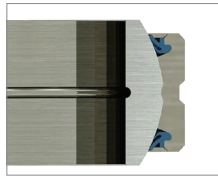

Sealed

Product Description

The standard radial spherical plain bearing is characterized by an outer ring with a single split in the axial direction. The outer and inner ring are made of chrome steel that is hardened and phosphate treated.

The sliding surface is treated with molybdenum disulfide. In addition to the treated sliding surface, the bearing receives lubrication through ports on the inner and outer bearing wall. Due to the molybdenum disulfide treatment and ability to self-lubricate, these bearings experience high wear resistance. This bearing performs well in applications exposed to dusty environments.

Part Numbers:

SBB - GEZ _____ ES - _____
 |
 I.D. (mm)
 Blank - Unsealed Style
 2RS - Sealed Style

Example: SBB GEZ25ES - Spherical Ball Bearing, Steel-On-Steel, Radial, Maintenance Required, 1.000" I.D., 1.625" O.D.

Spherical Plain Bearings

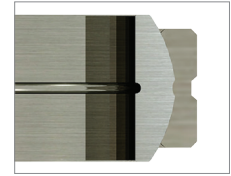
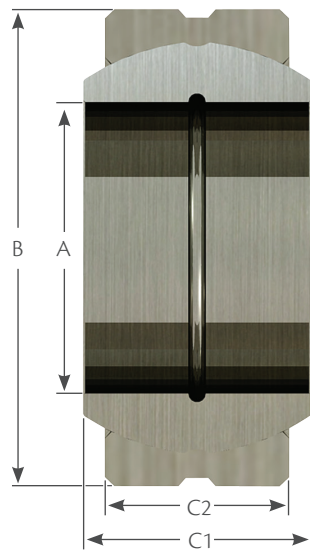

Additional styles and sizes available upon request.

Non-Sealed SBB Part Number	Sealed SSB Part Number	Bearing Dimensions				Basic Load Rating		IKO Dash Number
		A I.D	B O.D	C1 Height	C2	Dynamic kN	Static kN	
SBB GEZ12ES	Not Available	0.500	0.875	0.437	0.375	14	41.5	SBB 8
SBB GEZ15ES	Not Available	0.625	1.063	0.547	0.469	21.6	65.5	SBB 10
SBB GEZ19ES	Not Available	0.750	1.250	0.656	0.562	31.5	93	SBB 12
SBB GEZ22ES	Not Available	0.875	1.438	0.765	0.656	42.5	127	SBB 14
SBB GEZ25ES	SBB GEZ25ES-2RS	1.000	1.625	0.875	0.750	56	166	SBB 16 (-2RS)
SBB GEZ31ES	SBB GEZ31ES-2RS	1.250	2.000	1.093	0.937	86.5	260	SBB 20 (-2RS)
SBB GEZ34ES	SBB GEZ34ES-2RS	1.375	2.188	1.187	1.031	104	310	SBB 22 (-2RS)
SBB GEZ38ES	SBB GEZ38ES-2RS	1.500	2.438	1.312	1.125	125	375	SBB 24 (-2RS)
SBB GEZ44ES	SBB GEZ44ES-2RS	1.750	2.813	1.531	1.312	170	510	SBB 28 (-2RS)
SBB GEZ50ES	SBB GEZ50ES-2RS	2.000	3.188	1.750	1.500	224	670	SBB 32 (-2RS)
SBB GEZ57ES	SBB GEZ57ES-2RS	2.250	3.562	1.969	1.687	280	850	SBB 36 (-2RS)
SBB GEZ63ES	SBB GEZ63ES-2RS	2.500	3.938	2.187	1.875	345	1040	SBB 40 (-2RS)
SBB GEZ69ES	SBB GEZ69ES-2RS	2.750	4.375	2.406	2.062	425	1270	SBB 44 (-2RS)
SBB GEZ76ES	SBB GEZ76ES-2RS	3.000	4.750	2.625	2.250	500	1500	SBB 48 (-2RS)
SBB GEZ82ES	SBB GEZ82ES-2RS	3.250	5.125	2.844	2.437	585	1760	SBB 52 (-2RS)
SBB GEZ88ES	SBB GEZ88ES-2RS	3.500	5.500	3.062	2.625	680	2040	SBB 56 (-2RS)
SBB GEZ95ES	SBB GEZ95ES-2RS	3.750	5.875	3.281	2.812	780	2360	SBB 60 (-2RS)
SBB GEZ101ES	SBB GEZ101ES-2RS	4.000	6.250	3.503	3.000	900	2650	SBB 64 (-2RS)
SBB GEZ114ES	SBB GEZ114ES-2RS	4.500	7.000	3.937	3.375	1120	3400	SBB 72 (-2RS)
SBB GEZ127ES	SBB GEZ127ES-2RS	5.000	7.750	4.375	3.750	1400	4150	SBB 80 (-2RS)
SBB GEZ152ES	SBB GEZ152ES-2RS	6.000	8.750	4.750	4.125	1730	5200	SBB 96 (-2RS)