

Buffer Seals

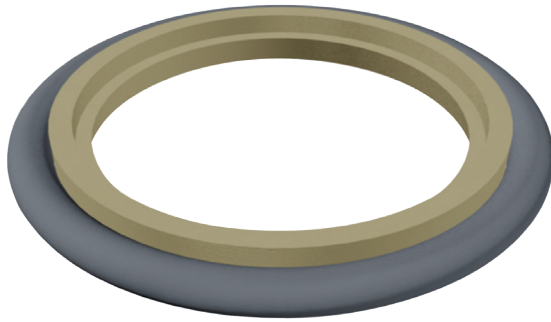

Materials	Temp. Range
15% Glass, 5% Moly filled PTFE	-268°C to 288°C
40% Bronze filled PTFE	-268°C to 288°C
Nylon	-30°C to 93°C
Low Temp. Nitrile	-54°C to 116°C
Nitrile	-40°C to 120°C
Viton™/Fluorocarbon	-26°C to 204°C
Urethane	-54°C to 105°C

Buffer Seals

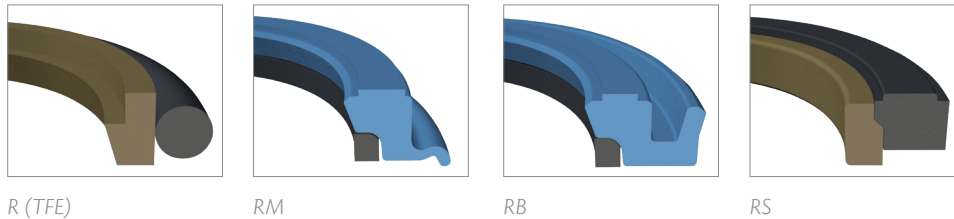

Caterpillar Equivalent Styles

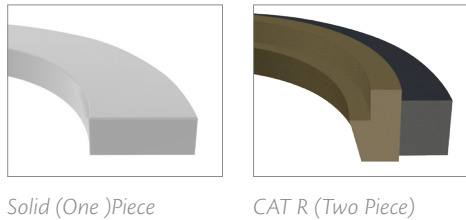

Product Description

We primarily stock rod buffer seals, though piston buffer seals are available upon request. Buffer seals are commonly used in combination with another rod or piston seal, typically a U-cup style seal. Buffer seals in rod applications are designed to absorb pressure fluctuations when working under high-load conditions, this increases the lifespan of a rod seal.

Part Numbers:

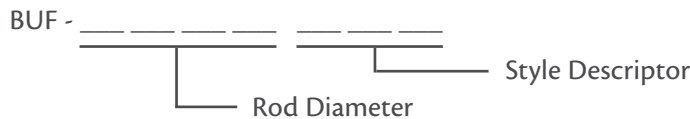

Example: BUF 1250TFE2 - R Style Buffer, 40% Bronze Filled PTFE, Nitrile loader, 1.250" Rod, N70 126 O-Ring

Design Information

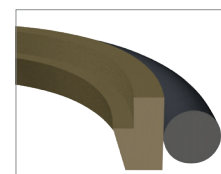
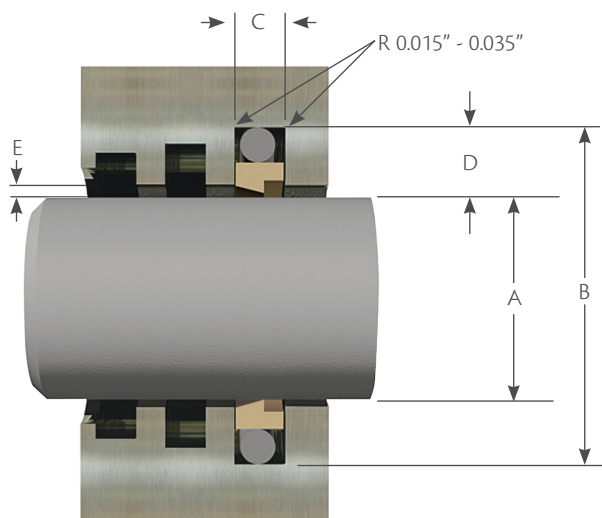

E is the maximum extrusion gap, which is the largest gap permitted by tolerances and eccentricity.

Rendering represents an R-Style Buffer Seal.

Style:	Description	Common Material(s)
R	Traditional, field proven design. Often used as a low friction rod seal.	40% Bronze PTFE, Nitrile Loader
RM	Easy to install buffer seal. Split anti-extrusion ring. Ideal for small diameters.	High Temperature Urethane, Nylon Back-Up
RB	Urethane cup style buffer with solid endless anti-extrusion ring.	High Temperature Urethane, Nylon Back-Up
RS	Heavy duty. Ideal for large rod heavy duty service.	40% Bronze PTFE, Nitrile Loader
Solid	One piece CAT Buffer Seal	Urethane
CAT R	Two piece CAT Buffer Seal	40% Bronze PTFE, Nitrile Loader

Information is intended as a guide only; contact a Hi-Tech Seals representative when designing a new application or altering a current application.

Buffer Seals

IMPERIAL SEALS

R-Style

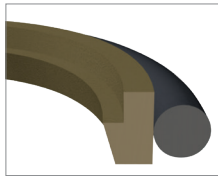

Max. Diametrical Clearance (E)

O-Ring C/S	@1000 PSI	@3000 PSI	@5000 PSI	Above 5000 PSI
3/32	0.018	0.016	0.008	Consult HTS
1/8	0.024	0.018	0.009	Consult HTS
3/16	0.030	0.024	0.018	Consult HTS
1/4	0.040	0.030	0.024	Consult HTS

Part Number	A		O-Ring C/S	B		C Groove Width +0.010/-0.000	D Groove Depth
	Shaft Diameter	Tol.		Groove Diameter	Tol.		
BUF 1000TFE	1.000	+0.000/-0.002	3/32	1.298	+0.003/-0.000	0.126	0.149
BUF 1000TFE1	1.000	+0.000/-0.003	1/8	1.424	+0.004/-0.000	0.166	0.212
BUF 1250TFE1	1.250	+0.000/-0.002	3/32	1.548	+0.003/-0.000	0.126	0.149
BUF 1250TFE2	1.250	+0.000/-0.003	1/8	1.674	+0.004/-0.000	0.166	0.212
BUF 1500TFE1	1.500	+0.000/-0.002	3/32	1.798	+0.003/-0.000	0.126	0.149
BUF 1500TFE	1.500	+0.000/-0.003	1/8	1.924	+0.004/-0.000	0.166	0.212
BUF 1500TFE2	1.500	+0.000/-0.004	3/16	2.116	+0.005/-0.000	0.247	0.308
BUF 1750TFE	1.750	+0.000/-0.003	1/8	2.174	+0.004/-0.000	0.166	0.212
BUF 1750TFE1	1.750	+0.000/-0.004	3/16	2.366	+0.005/-0.000	0.247	0.308
BUF 2000TFE	2.000	+0.000/-0.003	1/8	2.424	+0.004/-0.000	0.166	0.212
BUF 2000TFE1	2.000	+0.000/-0.004	3/16	2.616	+0.005/-0.000	0.247	0.308
BUF 2250TFE	2.250	+0.000/-0.003	1/8	2.674	+0.004/-0.000	0.166	0.212
BUF 2250TFE1	2.250	+0.000/-0.004	3/16	2.866	+0.005/-0.000	0.247	0.308
BUF 2500TFE1	2.500	+0.000/-0.003	1/8	2.924	+0.004/-0.000	0.166	0.212
BUF 2500TFE	2.500	+0.000/-0.004	3/16	3.116	+0.005/-0.000	0.247	0.308
BUF 2750TFE1	2.750	+0.000/-0.003	1/8	3.174	+0.004/-0.000	0.166	0.212
BUF 2750TFE	2.750	+0.000/-0.004	3/16	3.366	+0.005/-0.000	0.247	0.308
BUF 3000TFE1	3.000	+0.000/-0.003	1/8	3.424	+0.004/-0.000	0.166	0.212
BUF 3000TFE	3.000	+0.000/-0.004	3/16	3.616	+0.005/-0.000	0.247	0.308
BUF 3250TFE	3.250	+0.000/-0.004	3/16	3.866	+0.005/-0.000	0.247	0.308
BUF 3500TFE	3.500	+0.000/-0.004	3/16	4.116	+0.005/-0.000	0.247	0.308
BUF 3750TFE	3.750	+0.000/-0.004	3/16	4.366	+0.005/-0.000	0.247	0.308
BUF 4000TFE1	4.000	+0.000/-0.004	3/16	4.616	+0.005/-0.000	0.247	0.308
BUF 4000TFE	4.000	+0.000/-0.005	1/4	4.830	+0.006/-0.000	0.320	0.415
BUF 4250TFE	4.250	+0.000/-0.004	3/16	4.866	+0.005/-0.000	0.247	0.308
BUF 4250TFE1	4.250	+0.000/-0.005	1/4	5.080	+0.006/-0.000	0.320	0.415
BUF 4500TFE	4.500	+0.000/-0.004	3/16	5.116	+0.005/-0.000	0.247	0.308
BUF 4500TFE1	4.500	+0.000/-0.005	1/4	5.330	+0.006/-0.000	0.320	0.415

Part Number	A		O-Ring C/S	B		C Groove Width +0.010/-0.000	D Groove Depth
	Shaft Diameter	Tol.		Groove Diameter	Tol.		
BUF 4750TFE	4.750	+0.000/-0.004	3/16	5.366	+0.005/-0.000	0.247	0.308
BUF 4750TFE1	4.750	+0.000/-0.005	1/4	5.580	+0.006/-0.000	0.320	0.415
BUF 5000TFE	5.000	+0.000/-0.004	3/16	5.616	+0.005/-0.000	0.247	0.308
BUF 5000TFE1	5.000	+0.000/-0.005	1/4	5.830	+0.006/-0.000	0.320	0.415
BUF 5250TFE	5.250	+0.000/-0.004	3/16	5.866	+0.005/-0.000	0.247	0.308
BUF 5250TFE1	5.250	+0.000/-0.005	1/4	6.080	+0.006/-0.000	0.320	0.415
BUF 5500TFE	5.500	+0.000/-0.004	3/16	6.116	+0.005/-0.000	0.247	0.308
BUF 5500TFE	5.500	+0.000/-0.005	1/4	6.330	+0.006/-0.000	0.320	0.415
BUF 5750TFE	5.750	+0.000/-0.004	3/16	6.366	+0.005/-0.000	0.247	0.308
BUF 5750TFE1	5.750	+0.000/-0.005	1/4	6.580	+0.006/-0.000	0.320	0.415
BUF 6000TFE	6.000	+0.000/-0.004	3/16	6.616	+0.005/-0.000	0.247	0.308
BUF 6000TFE1	6.000	+0.000/-0.005	1/4	6.830	+0.006/-0.000	0.320	0.415
BUF 6250TFE	6.250	+0.000/-0.004	3/16	6.866	+0.005/-0.000	0.247	0.308
BUF 6250TFE1	6.250	+0.000/-0.005	1/4	7.080	+0.006/-0.000	0.320	0.415
BUF 6500TFE	6.500	+0.000/-0.004	3/16	7.116	+0.005/-0.000	0.247	0.308
BUF 6500TFE1	6.500	+0.000/-0.005	1/4	7.330	+0.006/-0.000	0.320	0.415
BUF 6750TFE	6.750	+0.000/-0.004	3/16	7.366	+0.005/-0.000	0.247	0.308
BUF 6750TFE1	6.750	+0.000/-0.005	1/4	7.580	+0.006/-0.000	0.320	0.415
BUF 7000TFE	7.000	+0.000/-0.004	3/16	7.616	+0.005/-0.000	0.247	0.308
BUF 7000TFE1	7.000	+0.000/-0.005	1/4	7.830	+0.006/-0.000	0.320	0.415
BUF 7250TFE	7.250	+0.000/-0.004	3/16	7.866	+0.005/-0.000	0.247	0.308
BUF 7250TFE1	7.250	+0.000/-0.005	1/4	8.080	+0.006/-0.000	0.320	0.415
BUF 7500TFE	7.500	+0.000/-0.004	3/16	8.116	+0.005/-0.000	0.247	0.308
BUF 7500TFE1	7.500	+0.000/-0.005	1/4	8.330	+0.006/-0.000	0.320	0.415
BUF 7750TFE	7.750	+0.000/-0.004	3/16	8.366	+0.005/-0.000	0.247	0.308
BUF 7750TFE1	7.750	+0.000/-0.005	1/4	8.580	+0.006/-0.000	0.320	0.415
BUF 8000TFE1	8.000	+0.000/-0.004	3/16	8.616	+0.005/-0.000	0.247	0.308
BUF 8000TFE	8.000	+0.000/-0.005	1/4	8.830	+0.006/-0.000	0.320	0.415
BUF 8500TFE	8.500	+0.000/-0.005	1/4	9.330	+0.006/-0.000	0.320	0.415
BUF 9000TFE	9.000	+0.000/-0.005	1/4	9.830	+0.006/-0.000	0.320	0.415
BUF 9500TFE	9.500	+0.000/-0.005	1/4	10.330	+0.006/-0.000	0.320	0.415
BUF 10000TFE	10.000	+0.000/-0.005	1/4	10.830	+0.006/-0.000	0.320	0.415
BUF 10500TFE	10.500	+0.000/-0.005	1/4	11.330	+0.006/-0.000	0.320	0.415
BUF 11000TFE	11.000	+0.000/-0.005	1/4	11.830	+0.006/-0.000	0.320	0.415
BUF 11500TFE	11.500	+0.000/-0.005	1/4	12.330	+0.006/-0.000	0.320	0.415
BUF 12000TFE	12.000	+0.000/-0.005	1/4	12.830	+0.006/-0.000	0.320	0.415

Buffer Seals

IMPERIAL SEALS

RM-Style

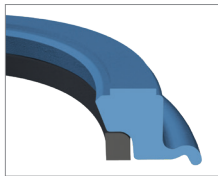

Max. Diametrical Clearance (E)

O-Ring C/S	@1000 PSI	@3000 PSI	@5000 PSI	Above 5000 PSI
1/8	0.022	0.018	0.012	Consult HTS
3/16	0.030	0.022	0.018	Consult HTS

Part Number	A		O-Ring C/S	B		C Groove Width +0.010/-0.000	D Groove Depth
	Shaft Diameter	Tol.		Groove Diameter	Tol.		
BUF 1000RM	1.000	+0.000/-0.003	1/8	1.424	+0.004/-0.000	0.166	0.212
BUF 1250RM	1.250	+0.000/-0.003	1/8	1.674	+0.004/-0.000	0.166	0.212
BUF 1500RM	1.500	+0.000/-0.003	1/8	1.924	+0.004/-0.000	0.166	0.212
BUF 1500RM1	1.500	+0.000/-0.004	3/16	2.116	+0.005/-0.000	0.247	0.308
BUF 1750RM	1.750	+0.000/-0.003	1/8	2.174	+0.004/-0.000	0.166	0.212
BUF 1750RM1	1.750	+0.000/-0.004	3/16	2.366	+0.005/-0.000	0.247	0.308
BUF 2000RM	2.000	+0.000/-0.003	1/8	2.424	+0.004/-0.000	0.166	0.212
BUF 2000RM1	2.000	+0.000/-0.004	3/16	2.616	+0.005/-0.000	0.247	0.308
BUF 2250RM	2.250	+0.000/-0.003	1/8	2.674	+0.004/-0.000	0.166	0.212
BUF 2250RM1	2.250	+0.000/-0.004	3/16	2.866	+0.005/-0.000	0.247	0.308
BUF 2500RM	2.500	+0.000/-0.003	1/8	2.924	+0.004/-0.000	0.166	0.212
BUF 2500RM1	2.500	+0.000/-0.004	3/16	3.116	+0.005/-0.000	0.247	0.308
BUF 2750RM	2.750	+0.000/-0.003	1/8	3.174	+0.004/-0.000	0.166	0.212
BUF 2750RM1	2.750	+0.000/-0.004	3/16	3.366	+0.005/-0.000	0.247	0.308
BUF 3000RM	3.000	+0.000/-0.003	1/8	3.424	+0.004/-0.000	0.166	0.212
BUF 3000RM1	3.000	+0.000/-0.004	3/16	3.616	+0.005/-0.000	0.247	0.308

RB-Style

Max. Diametrical Clearance (E)

O-Ring C/S	@1000 PSI	@3000 PSI	@5000 PSI	Above 5000 PSI
3/16	0.030	0.022	0.018	Consult HTS

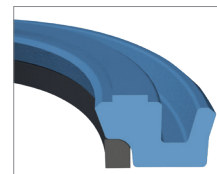

Buffer Seals

Part Number	A		O-Ring C/S	B		C Groove Width +0.010/-0.000	D Groove Depth
	Shaft Diameter	Tol.		Groove Diameter	Tol.		
BUF 1750RB	1.750	+0.000/-0.004	3/16	2.366	+0.005/-0.000	0.247	0.308
BUF 2250RB	2.250	+0.000/-0.004	3/16	2.866	+0.005/-0.000	0.247	0.308
BUF 2500RB	2.500	+0.000/-0.004	3/16	3.116	+0.005/-0.000	0.247	0.308
BUF 2750RB	2.750	+0.000/-0.004	3/16	3.366	+0.005/-0.000	0.247	0.308
BUF 3000RB	3.000	+0.000/-0.004	3/16	3.616	+0.005/-0.000	0.247	0.308
BUF 3500RB	3.500	+0.000/-0.004	3/16	4.116	+0.005/-0.000	0.247	0.308
BUF 4000RB	4.000	+0.000/-0.004	3/16	4.616	+0.005/-0.000	0.247	0.308
BUF 4250RB	4.250	+0.000/-0.004	3/16	4.866	+0.005/-0.000	0.247	0.308
BUF 4500RB	4.500	+0.000/-0.004	3/16	5.116	+0.005/-0.000	0.247	0.308
BUF 4750RB	4.750	+0.000/-0.004	3/16	5.366	+0.005/-0.000	0.247	0.308
BUF 5000RB	5.000	+0.000/-0.004	3/16	5.616	+0.005/-0.000	0.247	0.308
BUF 5250RB	5.250	+0.000/-0.004	3/16	5.866	+0.005/-0.000	0.247	0.308
BUF 5500RB	5.500	+0.000/-0.004	3/16	6.116	+0.005/-0.000	0.247	0.308
BUF 5750RB	5.750	+0.000/-0.004	3/16	6.366	+0.005/-0.000	0.247	0.308
BUF 6000RB	6.000	+0.000/-0.004	3/16	6.616	+0.005/-0.000	0.247	0.308
BUF 6250RB	6.250	+0.000/-0.004	3/16	6.866	+0.005/-0.000	0.247	0.308
BUF 6500RB	6.500	+0.000/-0.004	3/16	7.116	+0.005/-0.000	0.247	0.308
BUF 6750RB	6.750	+0.000/-0.004	3/16	7.366	+0.005/-0.000	0.247	0.308
BUF 7000RB	7.000	+0.000/-0.004	3/16	7.616	+0.005/-0.000	0.247	0.308
BUF 7250RB	7.250	+0.000/-0.004	3/16	7.866	+0.005/-0.000	0.247	0.308
BUF 7500RB	7.500	+0.000/-0.004	3/16	8.116	+0.005/-0.000	0.247	0.308
BUF 7750RB	7.750	+0.000/-0.004	3/16	8.366	+0.005/-0.000	0.247	0.308
BUF 8000RB	8.000	+0.000/-0.004	3/16	8.616	+0.005/-0.000	0.247	0.308

Buffer Seals

IMPERIAL SEALS

RS-Style

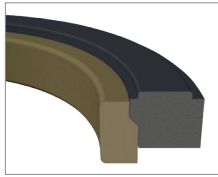

Max. Diametrical Clearance (E)

O-Ring C/S	@1000 PSI	@3000 PSI	@5000 PSI	Above 5000 PSI
3/16	0.040	0.030	0.024	Consult HTS
1/4	0.046	0.036	0.030	Consult HTS

Part Number	A		O-Ring C/S	B		C Groove Width +0.010/-0.000	D Groove Depth
	Shaft Diameter	Tol.		Groove Diameter	Tol.		
BUF 3000RS	3.000	+0.000/-0.004	3/16	3.616	+0.005/-0.000	0.247	0.308
BUF 3250RS	3.250	+0.000/-0.004	3/16	3.866	+0.005/-0.000	0.247	0.308
BUF 3500RS	3.500	+0.000/-0.004	3/16	4.116	+0.005/-0.000	0.247	0.308
BUF 3750RS	3.750	+0.000/-0.004	3/16	4.366	+0.005/-0.000	0.247	0.308
BUF 4000RS	4.000	+0.000/-0.004	3/16	4.616	+0.005/-0.000	0.247	0.308
BUF 4000RS1	4.000	+0.000/-0.005	1/4	4.830	+0.006/-0.000	0.320	0.415
BUF 4250RS	4.250	+0.000/-0.004	3/16	4.866	+0.005/-0.000	0.247	0.308
BUF 4250RS1	4.250	+0.000/-0.005	1/4	5.080	+0.006/-0.000	0.320	0.415
BUF 4500RS	4.500	+0.000/-0.004	3/16	5.116	+0.005/-0.000	0.247	0.308
BUF 4500RS1	4.500	+0.000/-0.005	1/4	5.330	+0.006/-0.000	0.320	0.415
BUF 4750RS	4.750	+0.000/-0.004	3/16	5.366	+0.005/-0.000	0.247	0.308
BUF 4750RS1	4.750	+0.000/-0.005	1/4	5.580	+0.006/-0.000	0.320	0.415
BUF 5000RS	5.000	+0.000/-0.004	3/16	5.616	+0.005/-0.000	0.247	0.308
BUF 5000RS1	5.000	+0.000/-0.005	1/4	5.830	+0.006/-0.000	0.320	0.415
BUF 5250RS	5.250	+0.000/-0.004	3/16	5.866	+0.005/-0.000	0.247	0.308
BUF 5250RS1	5.250	+0.000/-0.005	1/4	6.080	+0.006/-0.000	0.320	0.415
BUF 5500RS	5.500	+0.000/-0.004	3/16	6.116	+0.005/-0.000	0.247	0.308
BUF 5500RS1	5.500	+0.000/-0.005	1/4	6.330	+0.006/-0.000	0.320	0.415
BUF 5750RS	5.750	+0.000/-0.004	3/16	6.366	+0.005/-0.000	0.247	0.308
BUF 5750RS1	5.750	+0.000/-0.005	1/4	6.580	+0.006/-0.000	0.320	0.415
BUF 6000RS	6.000	+0.000/-0.004	3/16	6.616	+0.005/-0.000	0.247	0.308

Buffer Seals

RS-Style

Part Number	A		O-Ring C/S	B		C Groove Width +0.010/-0.000	D Groove Depth
	Shaft Diameter	Tol.		Groove Diameter	Tol.		
BUF 6000RS1	6.000	+0.000/-0.005	1/4	6.830	+0.006/-0.000	0.320	0.415
BUF 6250RS	6.250	+0.000/-0.004	3/16	6.866	+0.005/-0.000	0.247	0.308
BUF 6250RS1	6.250	+0.000/-0.005	1/4	7.080	+0.006/-0.000	0.320	0.415
BUF 6500RS	6.500	+0.000/-0.004	3/16	7.116	+0.005/-0.000	0.247	0.308
BUF 6500RS1	6.500	+0.000/-0.005	1/4	7.330	+0.006/-0.000	0.320	0.415
BUF 6750RS	6.750	+0.000/-0.004	3/16	7.366	+0.005/-0.000	0.247	0.308
BUF 6750RS1	6.750	+0.000/-0.005	1/4	7.580	+0.006/-0.000	0.320	0.415
BUF 7000RS	7.000	+0.000/-0.004	3/16	7.616	+0.005/-0.000	0.247	0.308
BUF 7000RS1	7.000	+0.000/-0.005	1/4	7.830	+0.006/-0.000	0.320	0.415
BUF 7250RS	7.250	+0.000/-0.004	3/16	7.866	+0.005/-0.000	0.247	0.308
BUF 7250RS1	7.250	+0.000/-0.005	1/4	8.080	+0.006/-0.000	0.320	0.415
BUF 7500RS	7.500	+0.000/-0.004	3/16	8.116	+0.005/-0.000	0.247	0.308
BUF 7500RS1	7.500	+0.000/-0.005	1/4	8.330	+0.006/-0.000	0.320	0.415
BUF 7750RS	7.750	+0.000/-0.004	3/16	8.366	+0.005/-0.000	0.247	0.308
BUF 7750RS1	7.750	+0.000/-0.005	1/4	8.580	+0.006/-0.000	0.320	0.415
BUF 8000RS	8.000	+0.000/-0.004	3/16	8.616	+0.005/-0.000	0.247	0.308
BUF 8000RS1	8.000	+0.000/-0.005	1/4	8.830	+0.006/-0.000	0.320	0.415
BUF 8500RS	8.500	+0.000/-0.005	1/4	9.330	+0.006/-0.000	0.320	0.415
BUF 9000RS	9.000	+0.000/-0.005	1/4	9.830	+0.006/-0.000	0.320	0.415
BUF 9500RS	9.500	+0.000/-0.005	1/4	10.330	+0.006/-0.000	0.320	0.415
BUF 10000RS	10.000	+0.000/-0.005	1/4	10.830	+0.006/-0.000	0.320	0.415
BUF 10500RS	10.500	+0.000/-0.005	1/4	11.330	+0.006/-0.000	0.320	0.415
BUF 11000RS	11.000	+0.000/-0.005	1/4	11.830	+0.006/-0.000	0.320	0.415
BUF 11500RS	11.500	+0.000/-0.005	1/4	12.330	+0.006/-0.000	0.320	0.415
BUF 12000RS	12.000	+0.000/-0.005	1/4	12.830	+0.006/-0.000	0.320	0.415
BUF 12500RS	12.500	+0.000/-0.005	1/4	13.330	+0.006/-0.000	0.320	0.415
BUF 13000RS	13.000	+0.000/-0.005	1/4	13.830	+0.006/-0.000	0.320	0.415
BUF 13500RS	13.500	+0.000/-0.005	1/4	14.330	+0.006/-0.000	0.320	0.415
BUF 14000RS	14.000	+0.000/-0.005	1/4	14.830	+0.006/-0.000	0.320	0.415
BUF 14500RS	14.500	+0.000/-0.005	1/4	15.330	+0.006/-0.000	0.320	0.415
BUF 15000RS	15.000	+0.000/-0.005	1/4	15.830	+0.006/-0.000	0.320	0.415
BUF 15500RS	15.500	+0.000/-0.005	1/4	16.330	+0.006/-0.000	0.320	0.415
BUF 16000RS	16.000	+0.000/-0.005	1/4	16.830	+0.006/-0.000	0.320	0.415

Buffer Seals

Caterpillar* One Piece Style

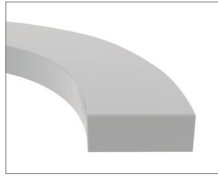

Part Number	Shaft Diameter	CAT Part Number
BUF 0875	0.875	5P4673
BUF 1250	1.250	9J3497
BUF 1500	1.500	6J9733
BUF 1750	1.750	6J9178
BUF 2000	2.000	6J6917
BUF 2250	2.250	5J3616
BUF 2375	2.375	6J6916
BUF 2500	2.500	5J3620
BUF 2750	2.750	6J6553
BUF 3000	3.000	6J6915
BUF 3250	3.250	6J7167

Part Number	Shaft Diameter	CAT Part Number
BUF 3500	3.500	6J6736
BUF 3750	3.750	8J6070
BUF 4000	4.000	8J4627
BUF 4250	4.250	7J8943
BUF 4375	4.375	3G5055
BUF 4750	4.750	7J9257
BUF 5000	5.000	8J4509
BUF 5500	5.500	8J9449
BUF 5750	5.750	9J5468
BUF 6500	6.500	6J8631
BUF 7000	7.000	9J2495

Caterpillar* Two Piece Style

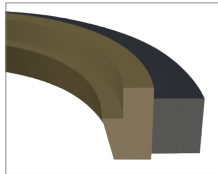

Part Number	Shaft Diameter	CAT Part Number
BUF 15001	1.500	8C9122
BUF 17501	1.750	8C9123
BUF 20001	2.000	8C9124
BUF 22501	2.250	8C9125
BUF 23751	2.375	8C9138
BUF 25001	2.500	8C3839
BUF 27501	2.750	8C3841
BUF 30001	3.000	8C9126
BUF 32501	3.250	8C9121
BUF 35001	3.500	8C9127
BUF 37501	3.750	8C9128
BUF 40001	4.000	8C9129

* Our Caterpillar parts are not original equipment parts. Caterpillar part numbers are only provided as a reference.